

MELO Atomizer User Manual

Notice for Use

Thank you for choosing Eleaf products! Please read this manual carefully before use so as to use correctly. If you require additional information or have questions about the product or its use, please consult your local agents, or visit our website at www.eleafworld.com.

Product Introduction

MELO atomizer is especially designed for Eleaf fans to better play with high output batteries. It is constructed out of stainless steel, along with its glass tube body and glass mouthpiece. The cotton applied is safe and certificated. The best working wattage for MELO is 20W-30W. The coil is sub ohm at 0.5 ohm to produce a smooth vape. The improved airflow control and surface stripe also make MELO more special.

Standard Configuration

- 1× MELO Mouthpiece
- 1× MELO Atomizer Tube
- 2× MELO Atomizer Head
- 1× MELO Atomizer Base

How to add liquid

1. Screw the base off atomizer firstly
2. Slowly refill the liquid into the space around the air pipe. Pay attention not over fill, leave a small air pocket in order to avoid leakage.

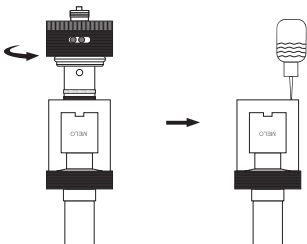

Note: Please make sure the atomizer head is always tightened up.

How to replace atomizer head

1. Screw the base off atomizer firstly
2. Screw off the atomizer head from base and replace a new one.

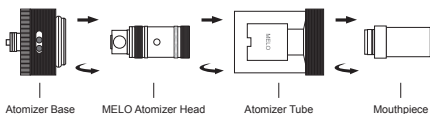

How to adjust airflow

There are totally five air inlet holes on the atomizer base. Through rotating the regulation ring clockwise, one can adjust airflow easily. The more the holes are covered by, the less the airflow is.

Precautions

- Only have your MELO atomizer repaired by Eleaf. Do not attempt to repair the unit by yourself as damage or personal injury may occur.
- Do not leave the MELO atomizer in high temperatures or damp conditions, otherwise it may be damaged.
- Do not attempt to combine the MELO atomizer with parts from other brands of e-cigarettes. If it is damaged in this way, our company will not take on responsibility and your warranty will be void.

Warranty

Please consult your Eleaf product warranty card. We are not responsible for any damages caused by human error. Our warranty is not available for products purchased from third-party vendors.

Email: info@ismoka.com
Web: www.eleafworld.com



MADE IN CHINA

Manufactured by iSmoka