

iKiss User Manual

Notice for Use

Thank you for choosing Eleaf product! Please read this manual carefully before use so that you can use it correctly. If you require more information or have questions about the product or its use, please consult your local agents, or visit our website at www.eleafworld.com.

Product Introduction

iKiss is featured by detachable, washable atomizer and all transparent liquid window. Mini size, diameter of 9.2 mm. Four option of colours---black, white, rose red and blue ---meets your demand. It is extremely easy to use. Its delicate appearance and mini size will make it handy and easy to carry.

Configuration

- 1×iKiss Atomizer Tube
- 2×iKiss Atomizer Head
- 1×iKiss Base
- 1×iKiss Battery
- 1×iKiss Extendable USB Cable
- 1×iKiss Wall Adapter

How to assemble

Screw iKiss atomizer tube on the iKiss Atomizer Base and iKiss Atomizer on iKiss Battery.

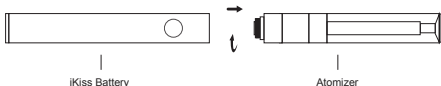

iKiss Atomizer

The cartridge of the iKiss and the atomizer is a one-piece. But the atomizer head is replaceable, this will be more convenient for you.

It adopts the unique way of air inflow and the transparent atomizer tube, so that you can clearly know the state of the liquid

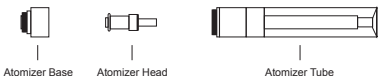

iKiss Power Supply

- Diameter: 9.2 mm
- Colour: Black, White, Rose red, Blue, Pink, Silver
- Capacity: 220 mAh/180mAh

Properties of iKiss battery

- a) High-safety, high-capacity, high-magnification and high-stability lithium battery.
- b) The battery adopts 3.3V constant voltage output, short circuit protection, over-charge and discharge protection, atomizer protection.
- c) Small-sized battery: 9.2mm (diameter)

How to charge

Plug the battery into its extendable USB cable. Then plug the USB port into the dedicated wall adapter or other power source such as a computer. When it is charging, the indicator light will flash. When fully charged, the indicator light will go out.

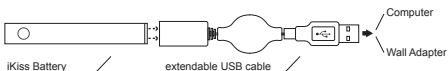

How to add liquid

Unscrew iKiss base and refill it from the bottom of iKiss atomizer. Please do not fill iKiss tube too full, and you'd better have a little room to spare.

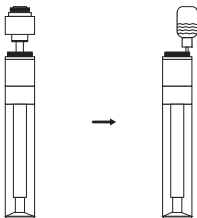

Precautions

- a) Have your iKiss repaired only by Eleaf. Do not repair the unit by yourself as damage or personal injury may occur.
- b) Do not leave iKiss in high temperature or damp condition, otherwise its performance may abate. The appropriate operation temperature is between 0 °C and 45 °C and the appropriate charging temperature between -10 °C and 60 °C.
- c) Do not assemble iKiss with non-Eleaf parts. Any problem caused by this will invalidate your warranty and our company will not take on any responsibility.

Warranty

Please consult your Eleaf product warranty card. We are not responsible for any damages caused by human error. Our warranty is invalid for products purchased from third-party vendors.

Email: info@ismoka.com
Web: www.eleafworld.com



MADE IN CHINA
Manufactured by iSmoka